

JAM NUTS (U.S. & METRIC)

FEATURES & BENEFITS

- Used with REB's, clevises & calibration adapters
- Flat, parallel surfaces
- Standard thread sizes

SPECIFICATIONS

MECHANICAL	
Material	Heat treated steel

STANDARD CONFIGURATION



Models JN-101, JN-105, & JN-107 (Shown)

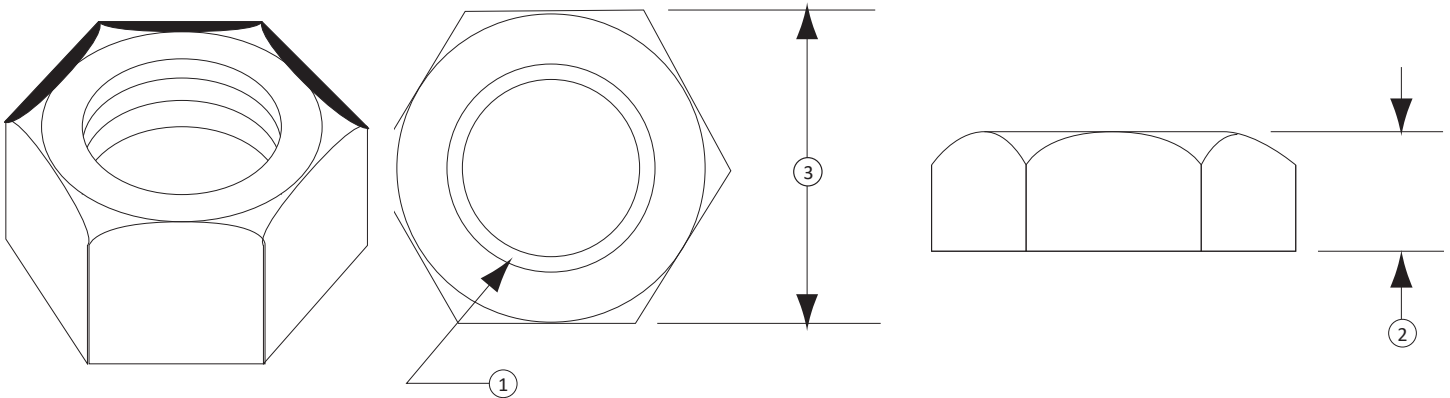

DIMENSIONS

See Drawing	U.S.	Metric	U.S.	Metric	U.S.	Metric	U.S.	Metric	U.S.	Metric	U.S.	Metric	U.S.	Metric
	Model													
	JN-101	JN-201	JN-102	JN-202	JN-103	JN-203	JN-104	JN-204	JN-105	JN-205	JN-106	JN-206	JN-107	JN-207
	in	mm	in	mm	in	mm	in	mm	in	mm	in	mm	in	mm
(1)	1/4-28	M6X1	1/2-20	M12X1.75	5/8-18	M16X2	3/4-16	M27X2	1 1/4-12	M33X2	1 3/4-12	M42X2	2 3/4-8	M72X2
(2)	0.219	5.0	0.438	10.0	0.547	13.0	0.641	18.8	0.880	25.4	1.250	31.8	1.900	48.3
(3)	0.438	10.0	0.750	19.0	0.938	24.0	1.125	47.6	1.880	57.0	2.750	70.0	4.250	110.0