

LOAD CELL CHARACTERISTICS	
CAPACITY	10000 (lbf)

Interface Inc. claims proprietary rights in the information disclosed herein. This drawing is furnished in confidence on the express understanding that neither it nor any reproduction thereof will be disclosed to others or used for the purpose of manufacture or procurement of the article or part shown hereon without written permission of Interface Inc. The drawing shall remain the property of Interface Inc. and shall be returned upon request by Interface Inc.

80027

REVISIONS			
REV.	DESCRIPTION	DATE	APPROVED
A	REDRAWN, UPDATED TO CURRENT STD'S	10/31/2018	RMP

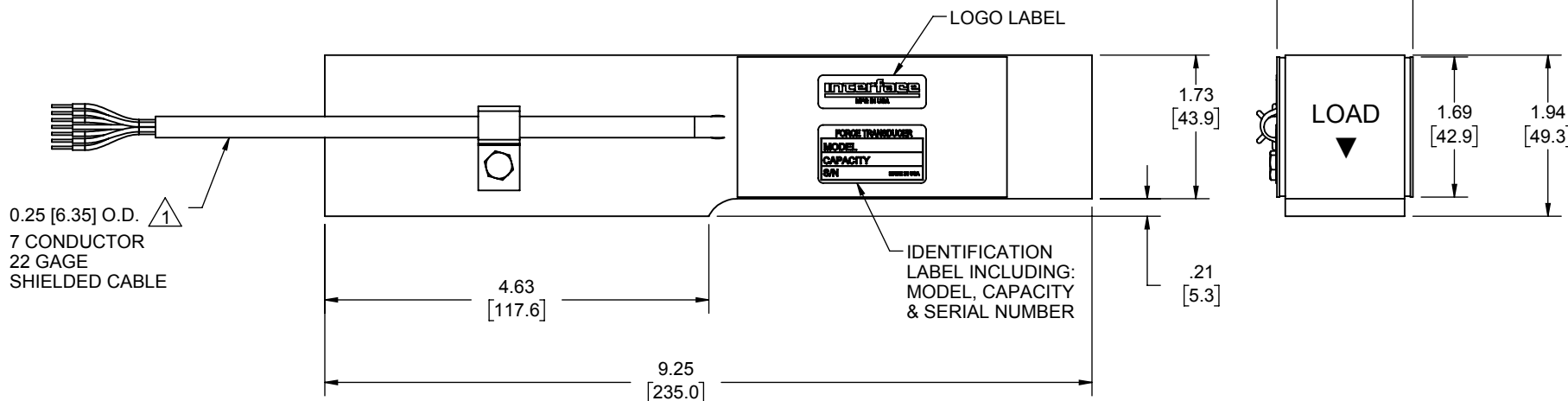
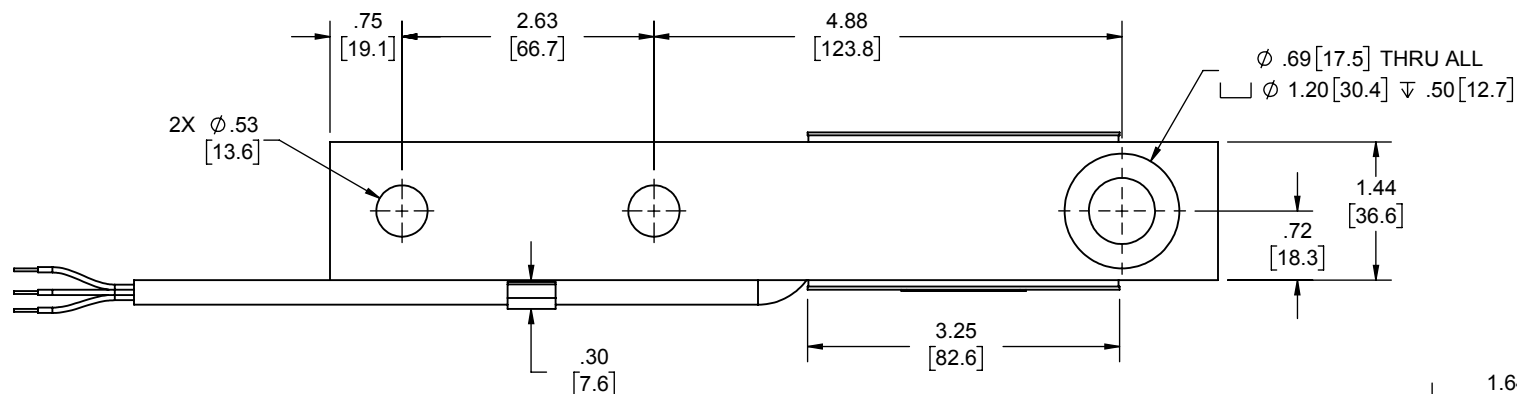

0.25 [6.35] O.D.  $\triangle 1$   
7 CONDUCTOR  
22 GAGE  
SHIELDED CABLE

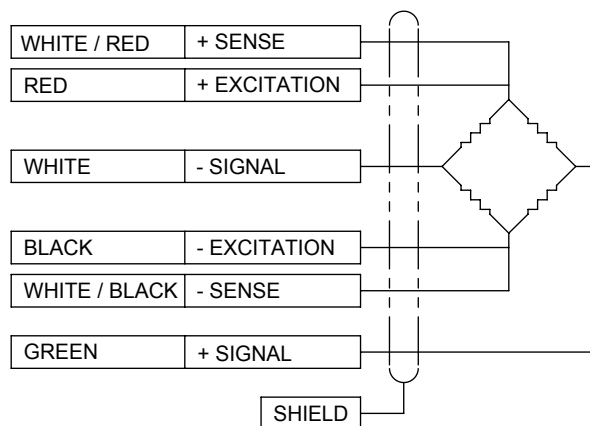

2.  
 $\triangle 1$

FLEXURE MATERIAL: NI-PLATED STEEL.  
STANDARD CABLE LENGTH IS 10 FT [3 M].  
NON-STANDARD CABLE LENGTH PER OPTION CODE.

UNLESS OTHERWISE SPECIFIED DIMENSIONS ARE IN INCHES [mm]	
TOLERANCES ARE:	
ANGLES	$\pm 0^{\circ} 30'$
.XX	$\pm .01$ [0.25]
.XXX	$\pm .005$ [0.13]
CREATOR	DATE
DESIGNED:	
DETAILED:	12/26/95
PER	
WEIGHT: (APPROX)	6.08 (lbs)

<b>Interface</b>		7418 E. HELM DRIVE
<b>FORCE MEASUREMENT SOLUTIONS</b>		SCOTTSDALE, AZ 85260 USA
TITLE:		OUTLINE MODEL:
		SSB-10000
SIZE:	DWG. NO:	REV:
A	80027	A
SCALE: 1:2	SHEET 1 OF 1	

CAD FILE <\_Document Vault:\-80027.SLD\*\*\*>