

REVISIONS			
REV	DESCRIPTION	DATE	APPROVED
A	INITIAL RELEASE	10-29-99	
B	REMOVED CONNECTOR PINOUTS	02-08-06	

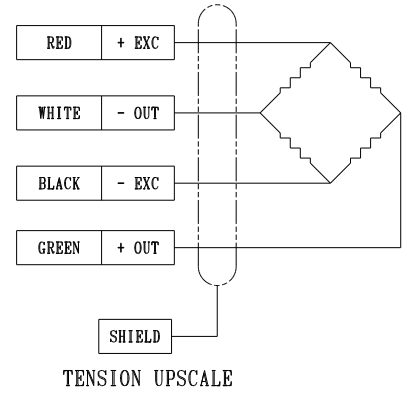
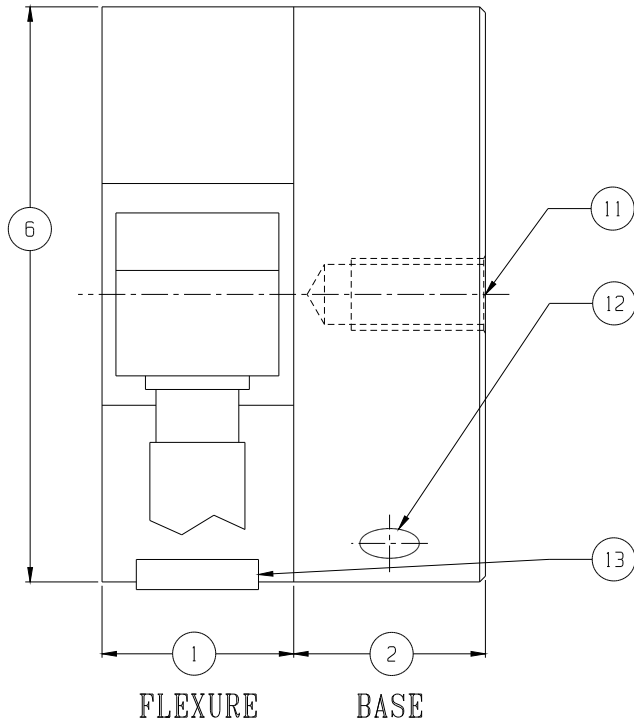
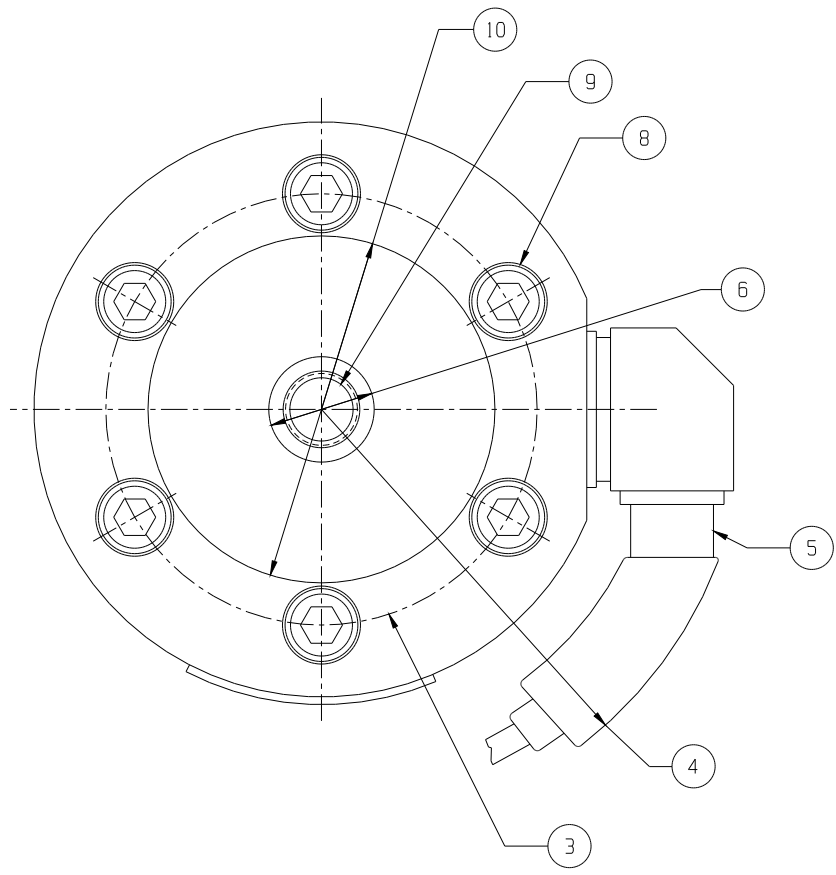

LOAD CELL CHARACTERISTICS		U.S. CAPACITIES
#	CAPACITY	50, 100, 250, 500, 1000 (lbf)
1	FLEXURE HEIGHT	1.00 (25.4)
2	BASE HEIGHT	1.00 (25.4)
3	MOUNTING BOLT CIRCLE	2.25 (57.2)
4	ROTATIONAL CLEARANCE (CABLE)	2.22 (56.3) MINIMUM
5	SUBMERSIBLE CABLE TYPE	0.24 (6.1) O.D. 4 CONDUCTOR 24 GAGE SHIELDED
6	OUTSIDE DIAMETER	3.00 (76.2)
7	HUB SURFACE DIAMETER	0.55 (14.0)
8	COUNTERBORED MOUNTING HOLES (FOR .250-28 S.H.C.S.)	Ø0.280 (7.11) THRU C*BORE Ø0.407 (10.34) X 0.275 (6.99) DEEP
9	FLEXURE THREAD AND DEPTH	0.375-24 UNF-3B, THRU
10	OUTER RING DIAMETER	1.81 (46.0)
11	BASE THREAD & DEPTH	0.375-24 UNF X 0.70 (17.8) DEEP
12	(2) SPANNER HOLES SPACED @ 180°	0.31 (7.87) X 0.31 (7.87) DEEP
13	IDENTIFICATION LABEL INCLUDING: MODEL, CAPACITY, SERIAL NUMBER & OUTPUT	

- 4. STANDARD CABLE LENGTH IS 20 FT (6.1M)
NON-STANDARD CABLE LENGTH PER OPTION CODE.
- 3. BASE IS OPTIONAL. MODEL NUMBERS ENDING IN (-B)
HAVE A BASE INSTALLED.
- 2. DIMENSIONAL TOLERANCE: +/- 0.01 (+/- 0.03)
- 1. DIMENSIONS IN INCHES & (MM)

Interface, Inc.
7401 E. BUTHERUS DR. SCOTTSDALE, ARIZONA 85260

TITLE: OUTLINE MODEL
2420 SUBMERSIBLE CABLE

DWG NO.: 80288

SIZE: A | DRAWN BY: JEP | DATE: 10-25-99 | REV: B

SCALE: 1:1 | APPROVED BY: | SHEET 1 OF 1

Interface Inc. claims propriety rights in the information disclosed herein. This drawing is furnished in confidence on the express understanding that neither it nor any reproduction thereof will be disclosed to others or used for the purpose of manufacture or procurement of the article or part shown herein without written permission of Interface Inc. The drawing shall remain Interface's property and shall be returned on Interface's request.