

TS110a $\pm 20\text{Nm}$

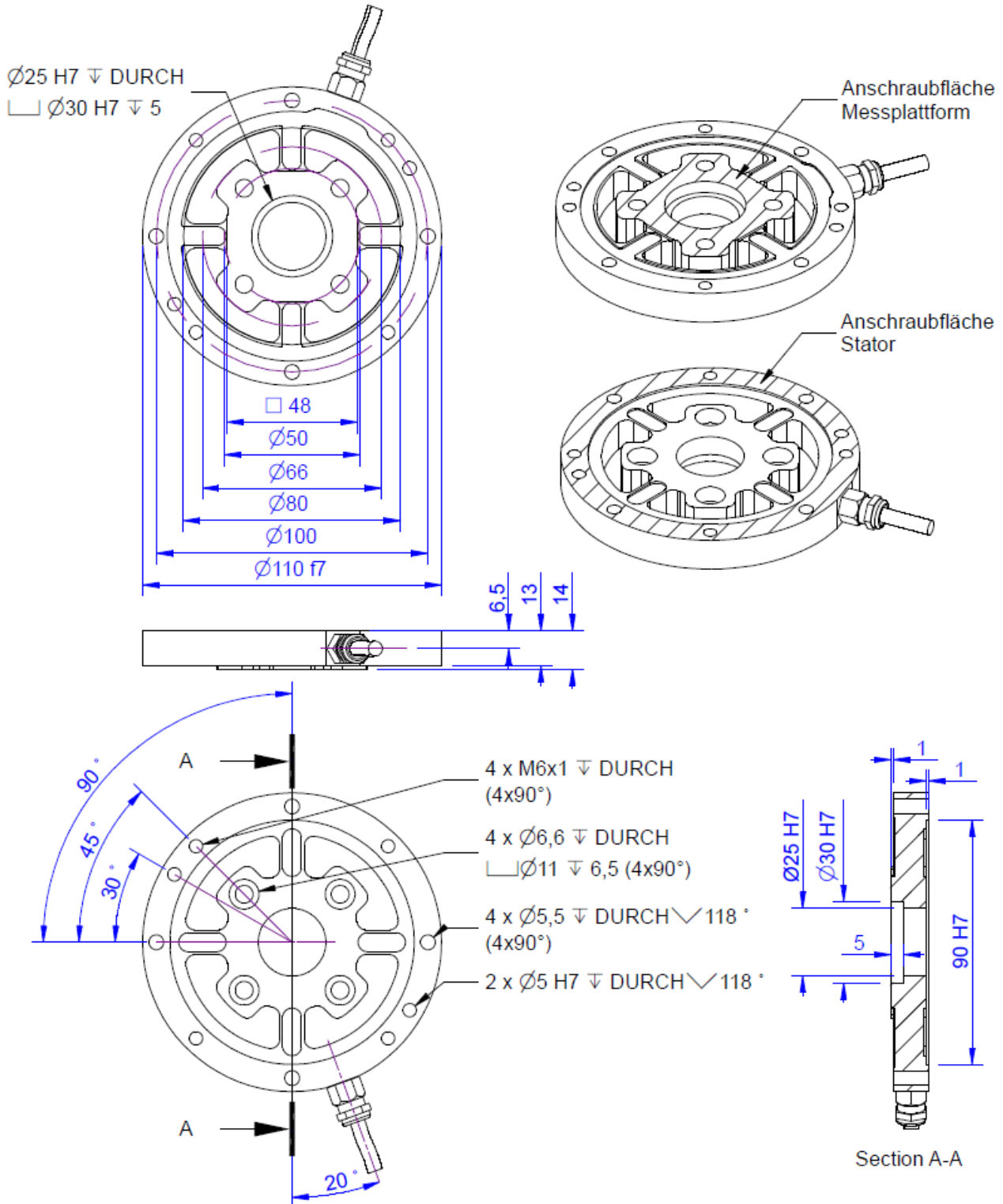

Dimensions



Technical Data

Electrical Data

Input resistance	2000	Ohm
Tolerance input resistance	10	Ohm
Output resistance	2000	Ohm
Tolerance output resistance	10	Ohm
Insulation resistance	5	GOhm
Rated range of excitation voltage f	2.5 ... 5	V
Operating range of excitation voltage f	1 ... 10	V
Zero signal	0.05	mV/V
Rated output	1	mV/V / FS

Precision

Accuracy class	0.1	
Relative linearity error	0.1	%FS
Relative zero signal hysteresis	0.1	%FS
Temperature effect on zero signal	0.01	%FS/K
Temperature effect on characteristic value	0.01	%RD/K
Relative creep	0.05	%FS

Connection Data

Connection type	4 conductor open
Name of the connection	Unitronic FD CP Plus / 4x0,14
Cable length	3 m

Temperature

Rated temperature range f	-10 ... 60	°C
Operating temperature range f	-10 ... 85	°C
Storage temperature range f	-10 ... 85	°C
Environmental protection	IP65	

Basis Data

Type	shear beam
Rated torque	20 Nm
Bending moment limit	20 Nm
Maximum operating torque	150 %FS
Breaking torque	400 %FS
Rated torsion angle	0.02 °/FS
Axial force limit	1000 N
Lateral force limit	1000 N
Torque introduction	pitch circle
Dimension 1	Ø50
drehmomentausleitung	pitch circle
Dimension 2	Ø100
Diameter	110 mm



length	14 mm
Material	Aluminium alloy

Abbreviation: RD: „Reading“; FS: „Full Scale“;

1) The exact nominal sensitivity is indicated in the test report;



Pin Configuration

Symbol	Description	Wire colour
+Us	positive bridge supply	brown
-Us	negative bridge supply	white
+Ud	positive bridge output	green
-Ud	negative bridge output	yellow

Pressure load: positive output signal.

Shield- transparent.

accessories

Description	Description
 Factory calibration certificate Nm/50/5	Detection of the characteristic value and traceability on DAkkS torque device; 0.025Nm... 50Nm
 Factory calibration certificate Nm/50/5/System	Detection of the characteristic value and traceability on DAkkS torque device; 0.025Nm... 50Nm; incl. calibration, torque sensor + amplifier