

GAIN AND OFFSET ADJUSTMENTS
SEALED (CODE 'Y')

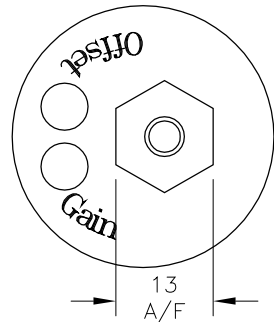

A	FIRST ISSUE - RAN1063	PDM
B	RANGE NOTE AMENDED ~ RAN1200	PDM



DRAWINGS NOT TO BE CHANGED WITHOUT REFERENCE TO THE CHANGE PROCEDURE.
CHANGES TO PARTS USED IN INTRINSICALLY SAFE PRODUCT MUST BE APPROVED
BY THE AUTHORISED PERSON
THIS IS AN UNCONTROLLED PRINT AND WILL NOT BE UPDATED.

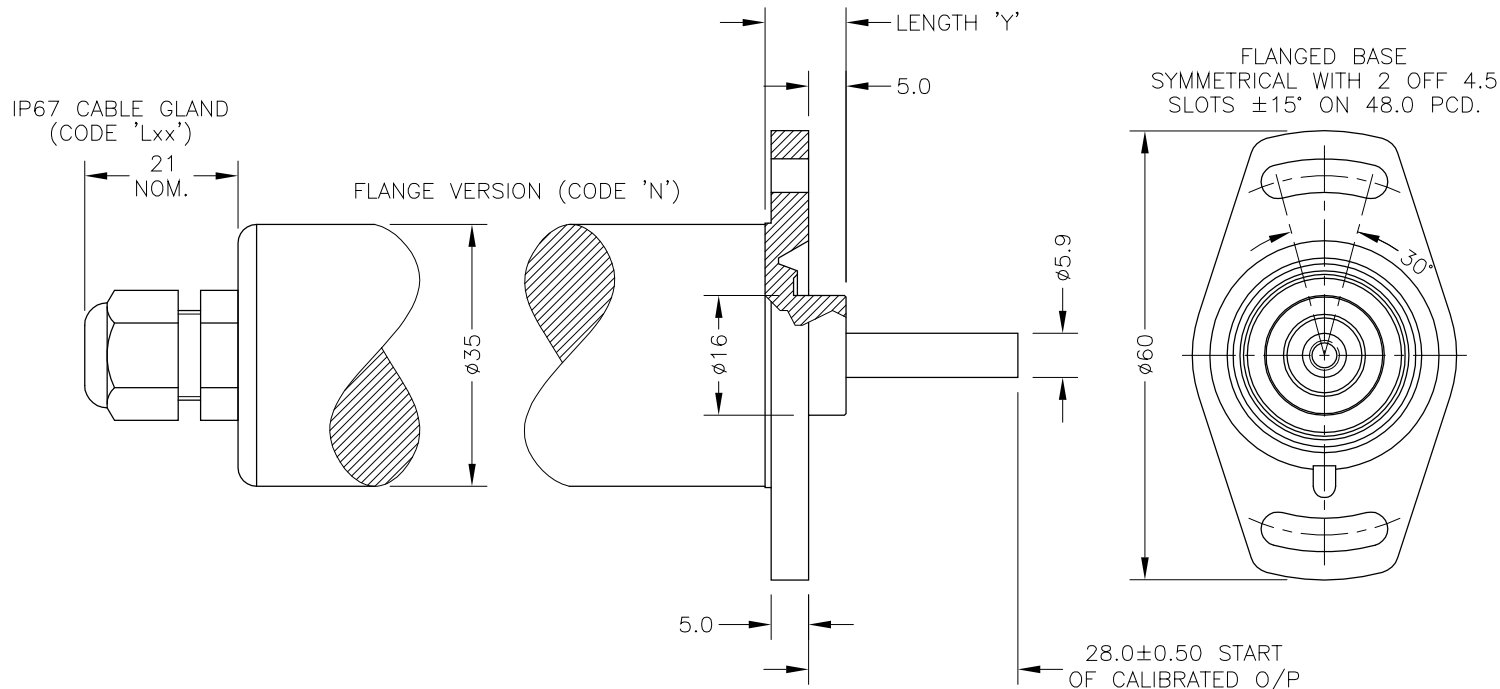
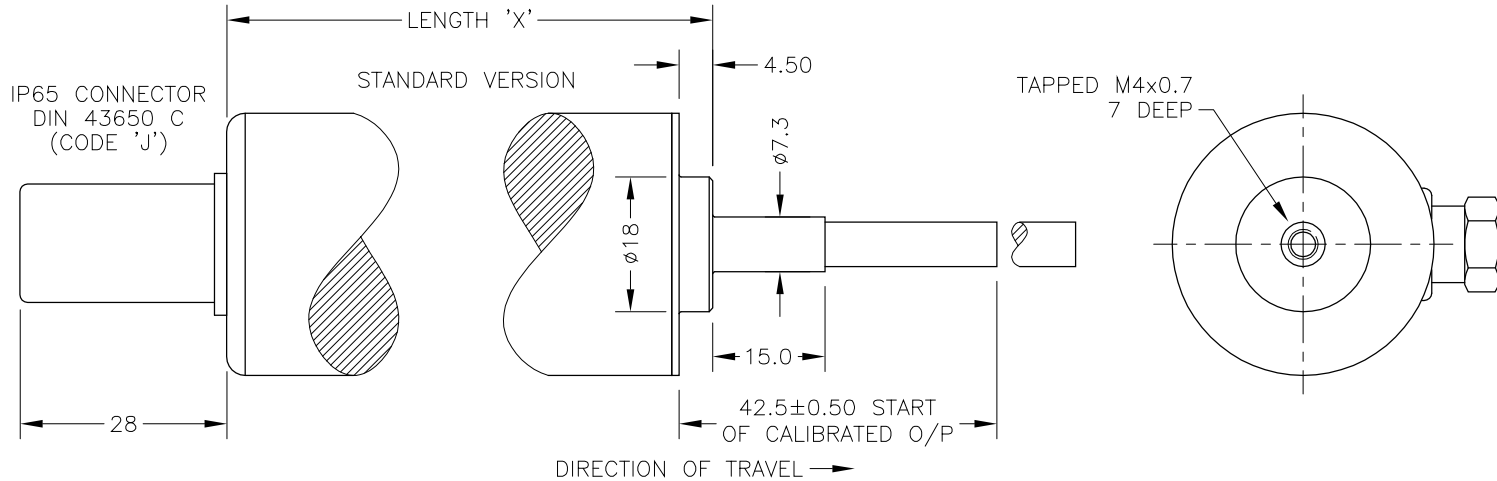

IP67 SHORT CABLE GLAND
(CODE 'Mxx')

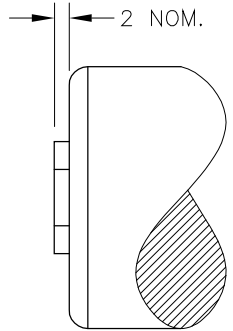

NOTE: SENSORS ARE MADE IN FOUR STANDARD LENGTHS.

TRAVEL: (mm)	BODY LENGTH: (mm)	
CALIBRATED MECHANICAL	'X' STANDARD	'Y' FLANGE
0-51 TO 0-70	70	125.0
0-71 TO 0-100	100	141.3
		171.3

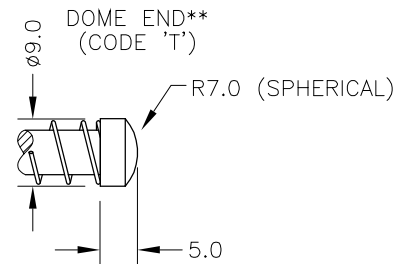

ELECTRICAL OPTIONS/ SPECIFICATIONS

OUTPUT OPTION	OUTPUT		SUPPLY	
	A	B	C	D
	0.5 TO 4.5V RATIOMETRIC	±5V	0.5 TO 9.5V	±10V
	0.5 TO 4.5V	SUPPLY CURRENT 12mA TYP.	20mA MAX.	
	4 TO 20mA 2-WIRE	24V		
	4 TO 20mA 3-WIRE SINK	24V		
	4 TO 20mA 3-WIRE SOURCE	24V		
	SINK VERSION OUTPUT COMPLIANCE 5-28V		SOURCE VERSION DRIVE 300Ω MAX TO 0V	

CABLE: 0.2mm², O/A SCREEN, PUR JACKET – SUPPLIED WITH 50cm OR REQUIRED LENGTH IN cm. e.g. 'L50'
3-CORE: JACKET ø4mm
4-CORE: JACKET ø4.6mm
CABLE/CONNECTOR* CONNECTIONS;
3 CORE 4 CORE CONNECTOR
RED RED :1 +Ve
BLACK GREEN :3 0V
YELLOW :4 -Ve – OPTIONS: B OR D
WHITE BLUE :2 OUTPUT
SCREEN SCREEN :4 BODY – OPTIONS: A, C, E-H

*CONNECTORS; MAXIMUM CONDUCTOR CROSS SECTION 0.75mm²
RANGE OF DISPLACEMENT FROM 0-51mm TO 0-100mm e.g.76, IN INCREMENTS OF 1mm.

BODY MATERIAL: STAINLESS STEEL.
FLANGE MATERIAL: ALUMINIUM (CODE 'N')

FURTHER OPTIONS:
SINGLE PAIR OF BODY CLAMPS (CODE 'P')
SPRUNG PLUNGER, TO EXTENDED POSITION (CODE 'R')
DOME END (CODE 'T') IN CONJUNCTION WITH SPRUNG PLUNGER (CODE 'R')**
PLUNGER FREE (CODE 'V')
N.b. NOT AVAILABLE WITH SPRUNG OPTIONS.

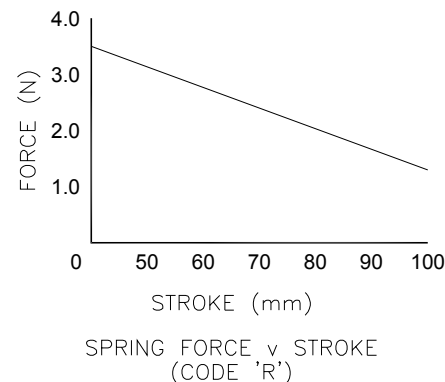

A	10/11/15		CHECKED BY	X	±0.4
B	29/08/17		RDS	X.X	±0.2
				X.XX	±0.1
				DIMS	mm
		DESCRIPTION			
		P133 LIPS MID STROKE LINEAR POSITION SENSOR			
SCALE 10mm		DRAWING NUMBER		P133-11	REV B
				SHEET 1 OF 1	