

## FEATURES & BENEFITS

- Capacities from 1K to 50K lbf (5 to 220 kN)
- Proprietary Interface temperature compensated strain gages
- Environmentally sealed
- Stainless steel construction (1K lbf or 5 kN is aluminum)
- Low deflection

## STANDARD CONFIGURATION



Model REC-5K (shown)

## SPECIFICATIONS

ACCURACY – (MAX ERROR)		
Nonlinearity – %FS		±0.25
Hysteresis – %FS		±0.15
Nonrepeatability – %FS		±0.05
TEMPERATURE		
Compensated Range	°F	+60 to +160
	°C	+15 to +72
Operating Range	°F	-60 to +200
	°C	-50 to +93
Effect on Output – %	°F	±0.005
	°C	±0.01
Effect on Zero – %RO	°F	±0.005
	°C	±0.01
ELECTRICAL		
Rated Output – mV/V (nominal)		2
Zero Balance – %RO		±3
Bridge Resistance – Ohm (nominal)		350
Excitation Voltage – VDC MAX		15
MECHANICAL		
Calibration		T & C
Safe Overload – %RO		150
Deflection	in	0.001
	mm	0.025
Material		Stainless steel (1K lbf or 5 kN aluminum)

RECv2.0 12-27-2017

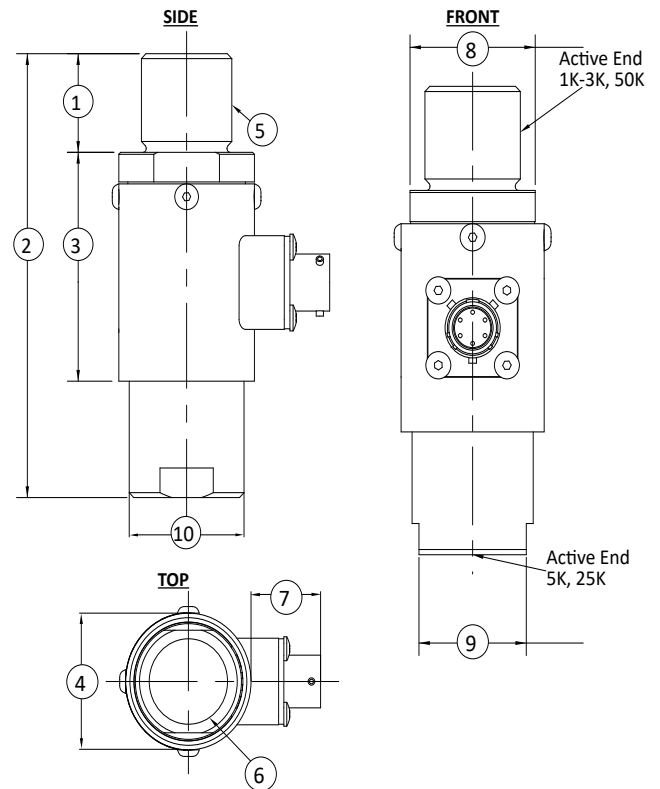

## DIMENSIONS

See Drawing	CAPACITY							
	US (lbf)	Metric (kN)	US (lbf)	Metric (kN)	US (lbf)	Metric (kN)	US (lbf)	Metric (kN)
	1K, 2K, 3K	5, 10, 13	5K, 10K	22, 45	15K, 20K, 25K	67, 90, 110	50K	220
	in	mm	in	mm	in	mm	in	mm
(1)	1.00	25.4	1.00	25.4	1.00	25.4	1.50	38.1
(2)	4.25	108	4.50	114.3	4.50	114.3	7.00	177.8
(3)	N/A	N/A	2.32	58.9	2.32	58.9	N/A	N/A
(4)	N/A	N/A	∅ 1.50	∅ 38.1	∅ 1.73	∅ 43.9	N/A	N/A
(5)	0.750-16 UNF-3A		1.00-14 UNS-2A		1.00-14 UNS-2A		1.500-12 UNF-2A	
	0.750-16 UNF-2B		1.00-14 UNS-2B		1.00-14 UNS-2B		1.500-12 UNF-2B	
(6)	∩ 0.88	∩ 22.4	∩ 1.0	∩ 25.4	∩ 1.0	∩ 25.4	∩ 1.5	∩ 38.1
(7)	0.83	21.1	0.83	21.1	0.85	21.6	0.71	18
(8)	Wrench Flats							
	1.13	28.7	1.31	33.3	1.50	38.1	1.75	44.5
(9)	Wrench Flats							
	1.31	33.3	1.13	28.7	1.31	33.3	2.25	57.2
(10)	1.50	38.1	∅ 1.27	∅ 32.3	∅ 1.50	∅ 38.1	∅ 2.50	∅ 63.5

**OPTIONS**

- PT02E-10-6P connector
- 5K-50K: MS3102E-14-5P connector optional
- Integral cable (10 ft or 3.05 m)
- Standardized output
- Special temperature range
- Custom calibration
- Transducer Electronic Data Sheet (TEDS)
- Standardized output

**ACCESSORIES**

- Instrumentation
- Mating Connector PT06A-10-6S-SR

**BAYONET CONNECTOR**



Model REC-XXX

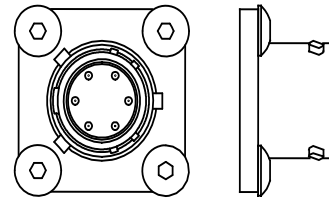

**SCREW TYPE CONNECTOR**



Model REC-XXX

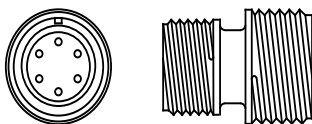

**INTEGRAL 10 FT. CABLE CONNECTOR**



Model REC-XXX

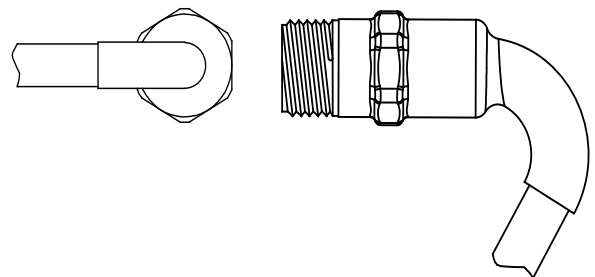

RECv2.0 12-27-2017