

# Model 1800 Platinum Standard™ Calibration Load Cell

Why the Interface model 1800 Platinum Standard™ Calibration Load Cell is the best in class:

- Handcrafted excellence for the most demanding calibration requirements
- Tension and compression in one unit
- .005% nonrepeatability
- 2% lower load limit per ASTM E74
- High precision base installed
- ASTM E74 calibration standard
- Internal electronic ID
- Eccentric load compensated
- .0008%/°F temp. effect on output
- Connector protector standard



\*Additional capacities available, call factory for details

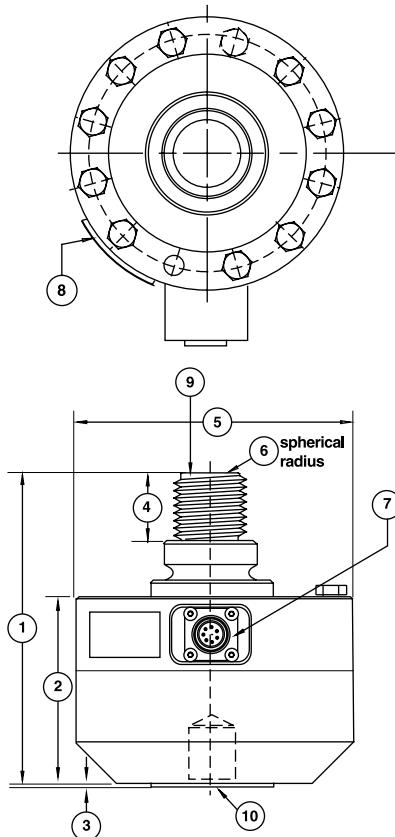

## DIMENSIONS

See Drawing	MODEL					
	1810		1820		1830	
	CAPACITY (lbf)					
	U.S. (lbf)	Metric (kN)	U.S. (lbf)	Metric (kN)	U.S. (lbf)	Metric (kN)
	1.1K, 2.2K 3.3K, 5.5K	5, 10 15, 25	11K, 22K	50, 100	55K	250
	inch	mm	inch	mm	inch	mm
①	4.65	118.1	6.85	174.0	8.26	209.7
②	3.28	83.3	4.13	104.9	5.00	127.0
③	0.03	0.80	0.03	0.80	0.03	0.80
④	0.75	19.1	1.50	38.1	1.88	47.8
⑤	4.13	104.9	6.06	154.0	8.00	203.2
⑥	6.00	152.4	6.00	152.4	8.00	203.2
⑦	PT02E-12-8P					
⑧	Identification Label					
⑨	5/8-18 UNF-3A	M16x2-4h	1 1/4-12 UNF-3A	M33x2-4h	1 3/4-12 UNF-3A	M42x2-4h
⑩	5/8-18 UNF-3B 0.75 deep	M16x2-4H 19.1	1 1/4-12 UNF-3B 1.25 deep	M33x2-4H 31.8	1 3/4-12 UNF-3B 2.00 deep	M42x2-4H 50.8

## SPECIFICATIONS

PARAMETERS	MODEL		
	1810	1820	1830
	<b>CAPACITY</b>		
U.S. Models (lbf)	<b>5.5K</b>	<b>11K, 22K</b>	<b>55K</b>
Metric Models (kN)	<b>25</b>	<b>50, 100</b>	<b>250</b>
<b>ACCURACY – (MAX ERROR)</b>			
Static Error Band–% FS	±0.020	±0.020	±0.025
Nonlinearity–% FS	±0.020	±0.020	±0.020
Hysteresis–% FS	±0.025	±0.025	±0.030
Nonrepeatability–% RO	±0.005	±0.005	±0.005
Creep, in 20 min–%	±0.01	±0.01	±0.01
Side Load Sensitivity–%	±0.1	±0.1	±0.1
Eccentric Load Sensitivity–%/in	±0.05	±0.05	±0.05
Lower Load Limit - % Cap. (ASTM E74 CLASS A)	2.0	2.0	2.0
<b>TEMPERATURE</b>			
Compensated Range–°F	15 to 115	15 to 115	15 to 115
Compensated Range–°C	-10 to 45	-10 to 45	-10 to 45
Operating Range–°F	-65 to 200	-65 to 200	-65 to 200
Operating Range–°C	-55 to 90	-55 to 90	-55 to 90
Effect on Zero–%RO/°F – MAX	±0.0004	±0.0004	±0.0004
Effect on Output–%/°F – MAX	±0.0008	±0.0008	±0.0008
<b>ELECTRICAL</b>			
Rated Output–mV/V (Nominal)	2.0	2.0	2.0
Excitation Voltage–VDC MAX	20	20	20
Bridge Resistance–Ohm (Nominal)	700	700	700
Zero Balance–% RO	±1.0	±1.0	±1.0
Insulation Resistance–Megohm	5000	5000	5000
<b>MECHANICAL</b>			
Safe Overload–% CAP	±300	±300	±300
Deflection @ RO–inch	0.001	0.001	0.002
Weight–lb	9	25	62
Connector	PT02E-12-8P	PT02E-12-8P	PT02E-12-8P
Calibration	T & C	T & C	T & C

### ACCESSORIES

Precision mV/V Transfer Standard  
 Instrument Cable Assemblies  
 Signal Conditioning Boards  
 Calibration Software

*Consult factory for more technical information*

### STANDARD CONFIGURATIONS

PT02E-12-8P Connector